

Designed by GamFratesi

PRODUCT



Item no

Table top: 10022FH-Ø105

Frame: 10022ST-Ø105

+ style code

DESCRIPTION

TS Table is designed by GamFratesi. TS table work together as a small group, complementing each other with its different sizes and heights, but they also work equally well as singles. TS Table is available in four sizes, with a marble/glass table top, black lacquered/brass frame.

VERSION

Bianco Carrara - white marble top // black lacquered frame / RAL 9005 gloss 15

Nero Marquina - black marble top // black lacquered frame / RAL 9005 gloss 15

Marrone Emperador - brown marble top // black lacquered frame / RAL 9005 gloss 15

Verde Guatemala - green marble top // black lacquered frame / RAL 9005 gloss 15

TYPES

Order item - look for part number in the pricelist.

The series consists of the following:

TS TABLE Ø40, TS TABLE Ø55, TS TABLE Ø80, TS TABLE Ø105, TS TABLE ROUND CONSOLE Ø40, TS TABLE 2 CONSOLE, TS TABLE 1 CONSOLE.



MEASUREMENTS

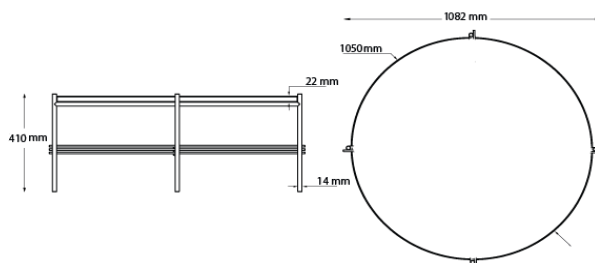

COLOURS



// Brown marble // black



// White marble // black



// Black marble // black



// Green marble // black

Notice: The TS lounge table X-large is not available in brass frame

FACTS

MEASUREMENT

Height: 410 mm

Width: 1082 mm

Table top diameter: 1050 mm

Table top thickness: 20 mm

Leg diameter: 14 mm

WEIGHT ITEM

Ø105: Table top 51,3 kg, Frame 5,5 kg

PACKAGING TYPE

Cardboard box, Chipboard, Foam

PACKAGING MEASUREMENT Ø105- L X W X H CM

Table top: L: 115 X W: 115 X H: 6,5 CM

Frame: L: 82 X W: 82 X H: 44 CM

WEIGHT PACKAGING - MATERIAL TYPE

Ø105 Table top:

- Delivery note: 5 g

- Chipboard: 24700 g

- Foam protector: 30 g

- Strapping: 10 g

Total: 24,745 kg

Ø105 Table frame:

- Delivery note: 5 g

- Cardboard: 1400 g

- Foam protector: 50 g

Total: 1,455 kg

WEIGHT TOTAL:

83 kg

NUMBER OF PARCELS

2 psc.

CLEANING AND MAINTENANCE

Black Lacquered Metal Frame

Daily cleaning is done by wiping the frame with a clean dry cloth, or with a cloth hardly wrung in clean water. Dirty surfaces are cleaned with a hardly wrung cloth out of soapy water or in water with added liquid soap. Wipe after with a clean dry cloth.

Marble Top

In order to protect the marble top against penetration of grease and alike, it is advisable to saturate the surface of the marble. We recommend using water with soap flakes or coconut soap. Rinse with semi hot water. Bees wax or a wax based on coconut oil may also be used. Apply the wax with a dry, undyed cloth. When the wax has dried completely in to the marble, polish the marble with a dry undyed cloth.

During the first 14 days of usage, we recommend that this is done 3-4 times. After that, when needed.

Please note that marble may change the expression and color depending on the treatment.

Normal cleaning is done by wiping with a cloth wrung out in hot water with liquid detergent or soapy water.

Marble is a limestone and does therefore not tolerate unfettered acid, such as vinegar, lemon juice, stains of wine, as well as aggressive and acidic cleaning products. Such stains may be impossible to remove. In case of spilling something acidic on the marble top, immediately wash away!

Do not use scouring pads or abrasive cleaners as this may damage the surface.

Heat Stress:

Marble can withstand heat in a short period of time, but does not tolerate extremely high temperatures. Glowing hot cookware directly from the stove can pull out the fat from the marble, and this will show as a spot or you risk that the top cracks. Therefore always use a trivet.

Do never pull any sharp or rough objects across the plat.

ENVIRONMENT

Parts can be separated and sorted for recycling.

TESTS

-

CERTIFICATION AND LABELS

-